

SURVEY OF CENTERLINE OF NAGEL DITCH #20-03
SW QUARTER OF SECTION 4, SE & SW QUARTERS OF SECTIONS 5 & 6
TOWNSHIP 5 NORTH, RANGE 5 EAST
ADAMS TOWNSHIP, DEFIANCE COUNTY, OH
SE QUARTER OF SECTION 1
TOWNSHIP 5 NORTH, RANGE 4 EAST
TIFFIN TOWNSHIP, DEFIANCE COUNTY, OH

#283
 Filed and Recorded this 26th
 Day of January, 2023 at 10:40 a.m.
 Plat Book Volume 15
 Page 5
Cecilia A. Parsons
 Defiance County Recorder
 \$0.00

All coordinates are based on GPS observation, Ohio State Plane North NAD83, 2005 and Grid north was used as the basis of bearing.

For documentation of the ditch centerline location. A maintenance area extends 25 feet from the top of ditch bank on either side of the constructed ditch.

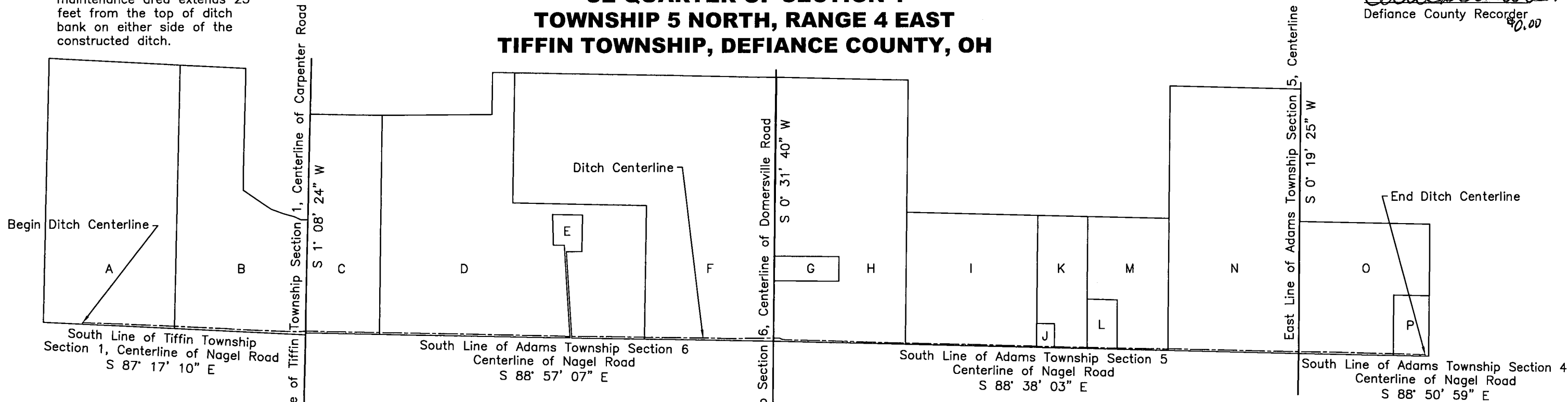

DEFIANCE COUNTY COMMISSIONERS
 Approved this 19th day of January, 2023

Mick Pocratsky
 Mick Pocratsky
David S. Kern
 David S. Kern
Dana Phipps
 Dana Phipps

I hereby certify this survey and notes to be correct to the best of my knowledge.

Warren Schlatter
 Warren J. Schlatter
 Defiance County Engineer
 Registered Surveyor No. 8106
 Certified this 13th day of January, 2023

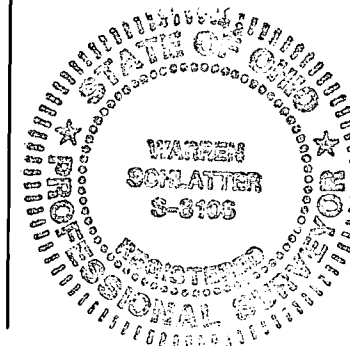

Parcels	
ID	Parcel Number
A	K14-0001-0-002-00
B	K14-0001-0-003-00
C	A07-0006-0-005-00
D	A07-0006-0-006-00
E	A07-0006-0-006-01
F	A07-0006-0-001-00
G	A07-0005-0-010-01
H	A07-0005-0-010-00
I	A07-0005-0-009-00
J	A07-0005-0-008-02
K	A07-0005-0-008-00
L	A07-0005-0-008-03
M	A07-0005-0-008-01
N	A07-0005-0-006-00
O	A07-0004-0-009-00
P	A07-0004-0-009-01

CONTROL POINTS	EASTING	NORTHING	ID
W¼ COR SEC 6, ADAMS TWP	1463444.63	644295.28	IP Cap
E¼ COR SEC 6, ADAMS TWP	1468137.53	644213.02	IP
E¼ COR SEC 5, ADAMS TWP	1473433.59	644092.36	IPipe Cap
SW¼, SE¼, NE¼, NW¼ COR SEC 4, ADAMS TWP	1476063.53	644036.72	IPipe Cap
S¼ COR SEC 4, ADAMS TWP	1476040.23	641386.43	IPipe
SE COR SEC 5, ADAMS TWP	1473418.60	641439.07	IPipe
S¼ COR SEC 5, ADAMS TWP	1470765.91	641502.75	IP Cap
SW COR SEC 5, ADAMS TWP	1468113.14	641565.56	IP
S¼ COR SEC 6, ADAMS TWP	1465458.56	641610.50	RR
SW COR SEC 6, ADAMS TWP	1463392.03	641651.93	IPipe Cap
SE COR SEC 1, TIFFIN TWP	1463391.72	641633.14	IPipe Cap
S¼ COR SEC 1, TIFFIN TWP	1460752.42	641758.25	IP Cap

Ditch Centerline Survey							
Eastings	Northings	Bearing	Distance	Eastings	Northings	Bearing	Distance
1461145.6	641754.4	S87° 44' 30"E	226.0	1466950.3	641603.1	S89° 23' 28"E	524.7
1461371.5	641745.5	S88° 42' 58"E	121.2	1467475.0	641597.6	S88° 07' 30"E	176.2
1461492.7	641742.8	S87° 41' 29"E	523.5	1467651.1	641591.8	N89° 23' 49"E	517.3
1462015.8	641721.7	S87° 04' 57"E	252.0	1468168.4	641597.2	S67° 19' 17"E	38.2
1462267.4	641708.9	S87° 38' 16"E	311.1	1468203.7	641582.5	S85° 19' 57"E	31.9
1462578.2	641696.1	S85° 55' 00"E	149.8	1468235.4	641579.9	S88° 31' 20"E	512.6
1462727.7	641685.4	S87° 45' 44"E	285.2	1468747.9	641566.7	S88° 04' 10"E	448.6
1463012.7	641674.3	S87° 55' 00"E	218.2	1469196.2	641551.6	S88° 33' 29"E	439.1
1463230.8	641666.3	S88° 51' 22"E	99.0	1469635.2	641540.5	S88° 55' 41"E	445.1
1463329.7	641664.3	N83° 23' 43"E	35.8	1470080.2	641532.2	S88° 22' 20"E	456.0
1463365.3	641668.5	N87° 20' 01"E	49.2	1470536.0	641519.2	S89° 03' 51"E	181.2
1463414.4	641670.7	S81° 56' 44"E	17.4	1470717.2	641516.3	S85° 30' 30"E	58.1
1463431.6	641668.3	S89° 15' 11"E	129.3	1470775.1	641511.7	S88° 50' 55"E	466.8
1463560.9	641666.6	S88° 10' 45"E	120.0	1471241.8	641502.4	S88° 32' 04"E	384.0
1463680.8	641662.8	S88° 59' 03"E	567.6	1471625.7	641492.5	S89° 10' 11"E	589.2
1464248.3	641652.7	S89° 00' 45"E	567.1	1472214.8	641484.0	S88° 43' 35"E	599.7
1464815.3	641643.0	S88° 45' 31"E	521.2	1472814.3	641470.7	S88° 41' 05"E	318.5
1465336.4	641631.7	S88° 50' 53"E	561.8	1473132.8	641463.4	S88° 58' 35"E	227.6
1465898.0	641620.4	S87° 53' 07"E	144.9	1473360.3	641459.3	S89° 05' 49"E	435.0
1466042.8	641615.0	S89° 38' 11"E	430.9	1473795.2	641452.4	S88° 26' 55"E	899.3
1466473.8	641612.3	S88° 53' 54"E	476.6	1474694.2	641428.1		

