

SURVEY OF CENTERLINES OF DESOTA TILE #20-05 SW QUARTER OF SECTION 33, TOWNSHIP 5 NORTH, RANGE 3 EAST WASHINGTON TOWNSHIP, DEFIANCE COUNTY, OH

#285
Filed and Recorded this 26th
Day of January, 2023 at 10:40 am
Plat Book Volume 15
Page 7
Cecilia Parsons
Defiance County Recorder
#0.00

| CONTROL POINTS | EASTING | NORTHING | ID |
|-------------------------------|------------|-----------|----|
| W¼ COR SEC 33 | 1409764.97 | 618791.81 | RR |
| SW¼, SE¼, NE¼, NW¼ COR SEC 33 | 1412418.48 | 618715.33 | RR |
| SW COR SEC 33 | 1409729.88 | 616132.66 | IP |

| 15" CPTS Tile Main Centerline Survey | | | |
|--------------------------------------|----------|---------------|----------|
| Eastings | Northing | Bearing | Distance |
| 1412358.1 | 618065.3 | N76° 31' 57"W | 30.5 |
| 1412328.4 | 618072.4 | N83° 49' 55"W | 23.6 |
| 1412305.0 | 618074.9 | N86° 37' 32"W | 54.9 |
| 1412250.2 | 618078.1 | N88° 24' 08"W | 499.9 |
| 1411750.5 | 618092.1 | N88° 52' 27"W | 661.1 |
| 1411089.5 | 618105.1 | N39° 21' 54"W | 1.1 |
| 1411088.8 | 618105.9 | N7° 08' 11"E | 26.6 |
| 1411092.1 | 618132.3 | N3° 50' 05"E | 98.2 |
| 1411098.7 | 618230.3 | N2° 00' 44"E | 107.9 |
| 1411102.5 | 618338.2 | N0° 10' 09"E | 403.5 |
| 1411103.7 | 618741.7 | | |

| 6" CPT Tile Submain #1 Centerline Survey | | | |
|------------------------------------------|----------|---------------|----------|
| Eastings | Northing | Bearing | Distance |
| 1412329.3 | 618072.2 | S13° 28' 03"W | 2.0 |
| 1412328.9 | 618070.2 | S62° 17' 30"W | 43.6 |
| 1412290.2 | 618049.9 | N88° 17' 18"W | 470.4 |
| 1411820.1 | 618063.9 | N88° 42' 29"W | 213.3 |
| 1411606.8 | 618068.8 | N88° 46' 55"W | 134.7 |
| 1411472.1 | 618071.6 | N88° 47' 05"W | 383.4 |
| 1411088.9 | 618079.7 | | |

| 6" CPT Tile Submain #2 Centerline Survey | | | |
|------------------------------------------|----------|---------------|----------|
| Eastings | Northing | Bearing | Distance |
| 1411089.2 | 618109.1 | N82° 51' 49"W | 21.9 |
| 1411067.5 | 618111.8 | N1° 33' 17"E | 188.9 |
| 1411072.7 | 618300.7 | N0° 30' 46"E | 76.9 |
| 1411073.3 | 618377.6 | N1° 20' 43"E | 304.8 |
| 1411080.5 | 618682.3 | N3° 57' 35"W | 29.9 |
| 1411078.4 | 618712.1 | N1° 10' 17"E | 27.0 |
| 1411079.0 | 618739.1 | | |

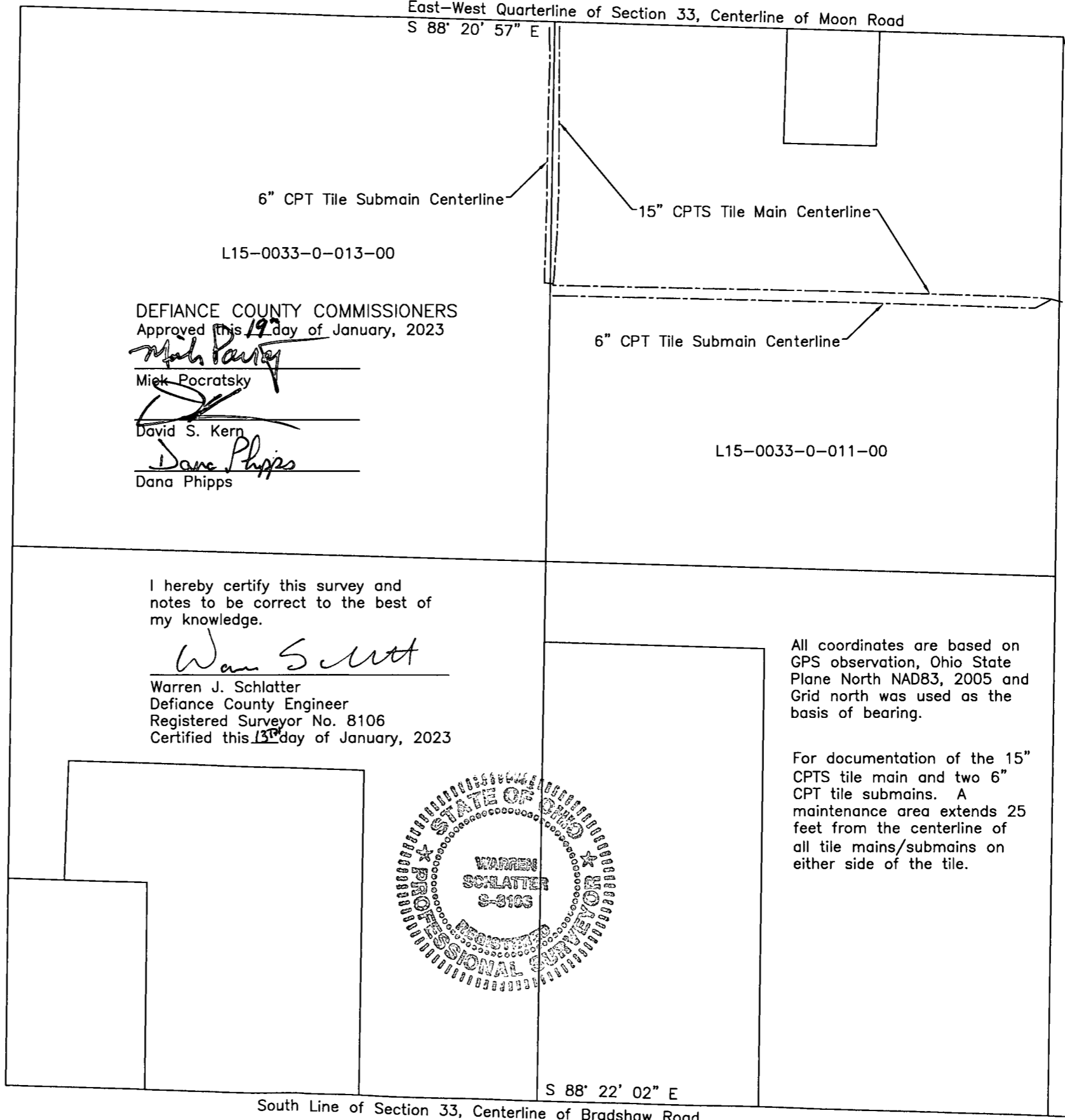

DEFIANCE COUNTY COMMISSIONERS
Approved this 19th day of January, 2023
Mick Pocratsky
Mick Pocratsky
David S. Kern
David S. Kern
Dana Phipps
Dana Phipps

I hereby certify this survey and notes to be correct to the best of my knowledge.

Warren J. Schlatter
Warren J. Schlatter
Defiance County Engineer
Registered Surveyor No. 8106
Certified this 13th day of January, 2023

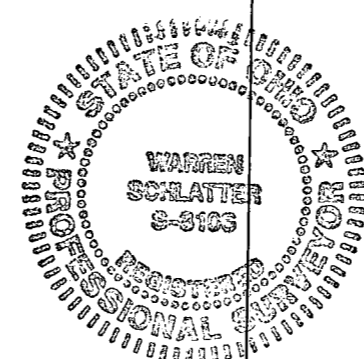

All coordinates are based on GPS observation, Ohio State Plane North NAD83, 2005 and Grid north was used as the basis of bearing.

For documentation of the 15" CPTS tile main and two 6" CPT tile submains. A maintenance area extends 25 feet from the centerline of all tile mains/submains on either side of the tile.

