

Porter Rd.

Porter Rd.

Plat of Survey

Being a part of the Northeast quarter (1/4) of the Southeast quarter (1/4) of Section 19, Township 3 North, Range 5 East, Highland Township, Defiance County, Ohio.

Thomas A. Friend, et.al.
Deed Ref: OR

Jacqueline K. Bowling
447/2879
28.966 Ac.

James E. & Heather L. Eiden
253/635
13.436 Ac.

Thomas A. Friend
267/635
36.31 Ac.

Survey Ref:
04-19-15
04-19-23

Legend

- A = Iron pin found
- B = Mag nail found
- C = Point Established Prev. Survey
- D = Mag nail set
- E = Iron pin & cap set

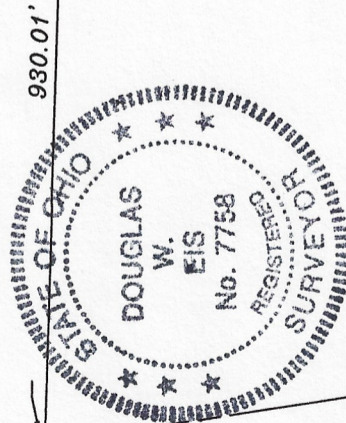

I hereby certify this survey and notes to be correct to the best of my knowledge.

Douglas W. Eis

Douglas W. Eis
Registered Surveyor No. 7758
16-883 St. Rt. 281
Holgate, Ohio 43527
(419) 438-5786
surveyor@henry-net.com
March 5, 2024
Survey No. B3178-D-Hig-3-18-24

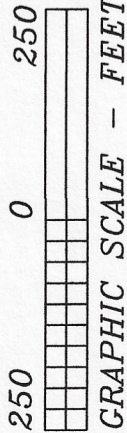

D.W. Eis Surveying
16-883 State Route 281
Holgate, Ohio 43527

Douglas W. Eis
Registered Surveyor No. 7758

Ph: (419) 438-5786
surveyor@henry-net.com

Description of land for: Friend to Eiden, 4.584 Ac.

Being a part of the Northeast quarter (1/4) of the Southeast quarter (1/4) of Section 19, Township 3 North, Range 5 East, Highland Township, Defiance County, Ohio and which is more particularly described as follows;

Commencing at an iron pin found at the Northeast corner of the Southeast quarter (1/4) of Section 19;

Thence South $1^{\circ}32'38''$ West, (assumed bearing for the purpose of this description), on the East line of the Southeast quarter (1/4) of Section 19, three hundred thirteen and fifty-three hundredths (313.53) feet to a point;

Thence North $88^{\circ}28'47''$ West, five hundred seventy-seven and fifty hundredths (577.50) feet, passing an iron pin found at twenty-five and zero hundredths (25.00) feet to an iron pin found;

Thence South $1^{\circ}32'38''$ West, three hundred thirty-five and forty-seven hundredths (335.47) feet to an iron pin and cap set and the point of beginning for the parcel herein described;

Thence continuing South $1^{\circ}32'38''$ West, six hundred seventy-eight and zero hundredths (678.00) feet to an iron pin found on the South line of the Northeast quarter (1/4) of the Southeast quarter (1/4) of Section 19;

Thence North $88^{\circ}28'47''$ West, on the South line of the Northeast quarter (1/4) of the Southeast quarter (1/4) of Section 19, three hundred seven and zero hundredths (307.00) feet to an iron pin and cap set;

Thence North $3^{\circ}39'20''$ East, on a new division line, six hundred seventy-eight and forty-seven hundredths (678.47) feet to an iron pin and cap set;

Thence South $88^{\circ}28'47''$ East, on a new division line, two hundred eighty-two and zero hundredths (282.00) feet to the point of beginning.

Containing 4.584 acres of land more or less. Subject to all legal highways, easements, zoning regulations or restrictions of record.

This description is based on a field survey by Douglas W. Eis, Registered Surveyor No. 7758.

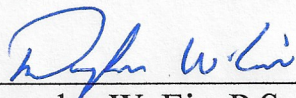

Douglas W. Eis, P.S.
Dated: March 18, 2024

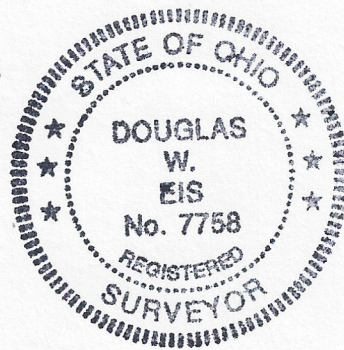

D.W. Eis Surveying
16-883 State Route 281
Holgate, Ohio 43527

Douglas W. Eis
Registered Surveyor No. 7758

Ph: (419) 438-5786
surveyor@henry-net.com

Description of land for: Thomas A. Friend, et.al, Remainder 22.272 Ac.

Being a part of the Northeast quarter (1/4) of the Southeast quarter (1/4) of Section 19, Township 3 North, Range 5 East, Highland Township, Defiance County, Ohio and which is more particularly described as follows;

Beginning at an iron pin found at the Northeast corner of the Southeast quarter (1/4) of Section 19;

Thence South $1^{\circ}32'38''$ West, (assumed bearing for the purpose of this description), on the East line of the Southeast quarter (1/4) of Section 19, three hundred thirteen and fifty-three hundredths (313.53) feet to a point;

Thence North $88^{\circ}28'47''$ West, five hundred seventy-seven and fifty hundredths (577.50) feet, passing an iron pin found at twenty-five and zero hundredths (25.00) feet to an iron pin found;

Thence South $1^{\circ}32'38''$ West, three hundred thirty-five and forty-seven hundredths (335.47) feet to an iron pin and cap set;

Thence North $88^{\circ}28'47''$ West, on a new division line, two hundred eighty-two and zero hundredths (282.00) feet to an iron pin and cap set;

Thence South $3^{\circ}39'20''$ West, on a new division line, six hundred seventy-eight and forty-seven hundredths (678.47) feet to an iron pin and cap set on the South line of the Northeast quarter (1/4) of the Southeast quarter (1/4) of Section 19;

Thence North $88^{\circ}28'47''$ West, on the South line of the Northeast quarter (1/4) of the Southeast quarter (1/4) of Section 19, four hundred thirty-nine and eighty hundredths (439.80) feet to an iron pin found at the Southwest corner of the Northeast quarter (1/4) of the Southeast quarter (1/4) of Section 19;

thence North $1^{\circ}34'14''$ East, on the West line of the Northeast quarter of the Southeast quarter (1/4) of Section 19. one thousand three hundred twenty-four and twenty-eight hundredths (1324.28) feet, passing an iron pin found at one thousand three hundred four and twenty-eight hundredths (1304.28) feet to a mag nail found at the Northwest corner of the Northeast quarter (1/4) of the Southeast quarter (1/4) of Section 19;

Thence South $88^{\circ}35'51''$ East, North line of the Southeast quarter (1/4) of Section 19, one thousand three hundred twenty-three and sixty-nine hundredths (1323.69) feet to the point of beginning.

Containing 22.272 acres of land more or less. Subject to all legal highways, easements, zoning regulations or restrictions of record.

This description is based on a field survey by Douglas W. Eis, Registered Surveyor No. 7758.

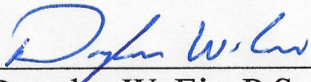

Douglas W. Eis, P.S.
Dated: March 18, 2024

